

SOLAQUAD® GLAZING PANELS

The SolaQuad® system design is comprised of Quadwall® assembly of dual glazed polycarbonate panels with built-in revolving arrays of SolaBlades®. Each SolaBlade® has an opaque, flat face, and the position of the SolaBlades® in relation to the sun determines the amount of sunlight and heat gain transmitted through the panel.

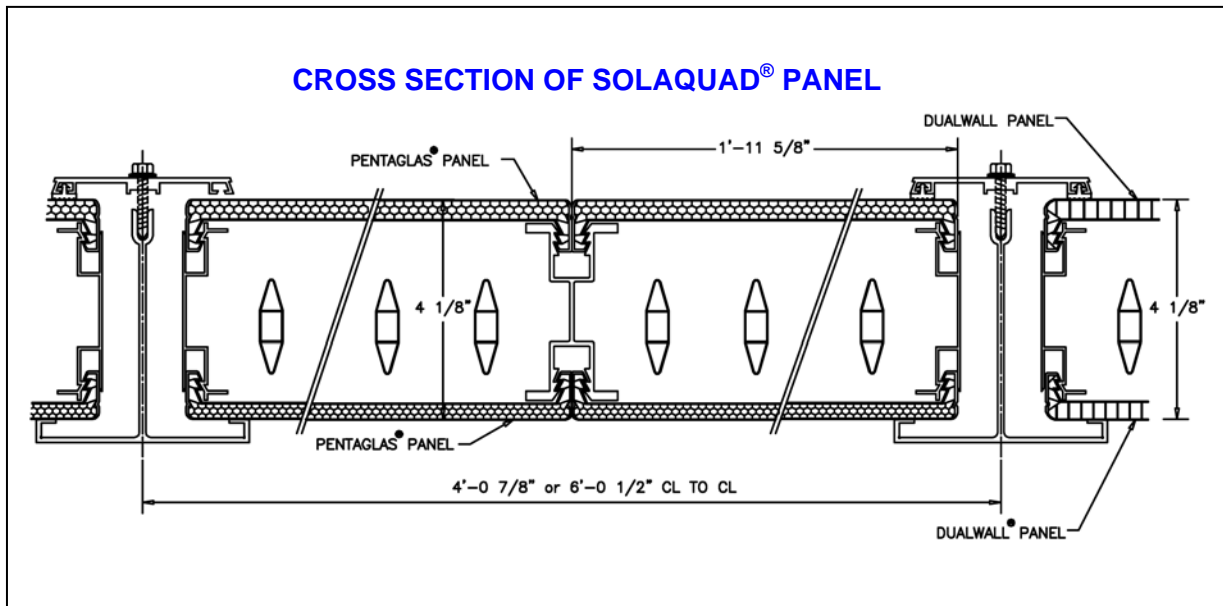

SolaBlade® Sun Tracking Options

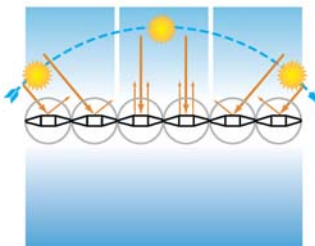

Minimum light transmission and solar heat gain

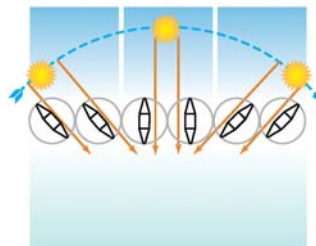

Maximum light transmission regardless of the sun's angle

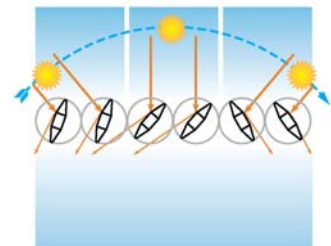

Angled to diffuse light transmission to suit user preference

The SolaBlades® can be set to deliver direct or diffused sunlight. By angling the sunlight that penetrates the space, the SolaBlades® make use of the physical fact that light hitting at an angle delivers less energy per square foot than direct sunlight. A sun-tracking sensor also allows alignment of the SolaBlades® to an optimal position in relation to the sun's position in the sky to harvest daylight that would otherwise be lost due to the low incident angle of the sun early and late in the day.

AVAILABLE GLAZING COLORS

The standard color for the translucent polycarbonate panels is clear over clear matte.

The standard color for the SolaBlades® is opaque white.

Additional colors for the main panel are available: Green, Blue, Ice White, White and Low-E Pearl.

Anti-Glare Diffusing Matte Finish – Proprietary matte finish can be added to the exterior and/or the interior glazing panels. The matte finish layer creates a diffusing surface that also acts as an anti-glare surface. The panel provides highest light transmission with excellent light distribution.

THERMAL AND LIGHT PERFORMANCE

SolaQuad® offers variable light transmission from 3% to 62% and any desired light transmission and corresponding shading coefficient between.

	Quadwall® Panels Configuration	
	Pentaglas®- Clear/Clear Matte (Standard)	Dualwall- Clear/Clear Matte
L.T% -in open position	52%	62%
L.T%-in closed position	3%	5%
SHGC -in open position	0.417	0.59
SHGC -in closed position	0.113	0.15
U Value of glazing panels	0.24	0.26

Notes: Glazing panel's colors affect the L.T% and SHGC. Glazing panel colors may be selected to achieve other desired optical and SHGC performance.

HOW SOLAQUAD® PANELS ARE VIEWED BY BUILDING CODES

- The SolaQuad® system is recognized as “Approved Plastics” with CC1 Classification, for use as light transmitting materials in buildings and structures as follows: Self-ignition temperature of 1000 degrees F per ASTM 1929, Smoke density of 54% per ASTM 2843, Burning Extend of CC1 per ASTM D635 and Interior Flame Spread of Class A (less than 25) per ASTM E-84

DOUBLE LAYERS OF PROTECTION

- SolaQuad® is an assembly of two panels containing multi isolated air spaces for increased insulation and provides superior performance for the cost.
 1. The patented standing seam connector allows the efficient addition of a second layer at a marginal extra cost.
 2. The two layers of glazing provide redundant protection of the covered space.
 3. The SolaQuad® system's longevity can be extended indefinitely by replacing exterior glazing panels without exposing the building's interior. The interior glazing panel remains intact for the life of the building envelope.
 4. In comparison, adding or replacing a double layer on other glazing systems would require significant extra cost; any damage to the exterior face would require intensive replacements that would interrupt the building's function.

